

# Chinasound Micro Speaker

## CMS15R3



Part Number	<b>CMS15R3-8N0.2-1T600R</b>	
Rated Impedance	(ohm)	8 ± 15%
Rated (Max.) Power	(W)	0.2 (0.3)
Resonance Frequency	(Hz)	600 ± 20%
Rated Frequency Range	(Hz)	f~ 3500
♦ Sound Pressure Level	(dB)	78 ± 3 at 1m1W
Operating Temperature	(°C)	-20~+60
Storage Temperature	(°C)	-30~+70
Weight	(g)	2.0

Dimensions (mm)

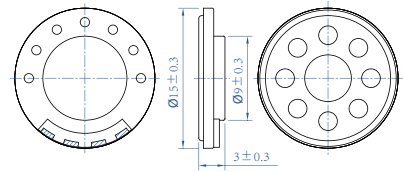

Frequency Curve

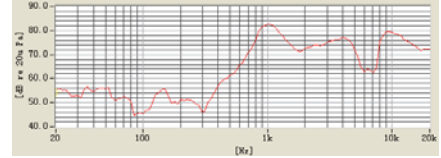

## CMS20R3.2



Part Number	<b>CMS20R3.2-4N0.5-2B840R</b>	
Rated Impedance	(ohm)	4 ± 15%
Rated (Max.) Power	(W)	0.5 (1)
Resonance Frequency	(Hz)	840 ± 20%
Frequency Range	(Hz)	f~ 20000
♦ Sound Pressure Level	(dB)	75 ± 3 at 1m1W
Operating Temperature	(°C)	-20~+60
Storage Temperature	(°C)	-30~+70
Weight	(g)	2.5

Dimensions (mm)

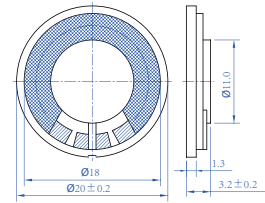

Frequency Curve



## CMS28R7



Part Number	<b>CMS28R7-32N0.6-1B650-C09W100R</b>	
Rated Impedance	(ohm)	8 ± 15%
Rated (Max.) Power	(W)	0.6 (1.2)
Resonance Frequency	(Hz)	650 ± 20%
Frequency Range	(Hz)	f~ 5000
♦ Sound Pressure Level	(dB)	97 ± 3 at 0.1m0.6W
Operating Temperature	(°C)	-30~+70
Storage Temperature	(°C)	-40~+70
Weight	(g)	9.6

Dimensions (mm)

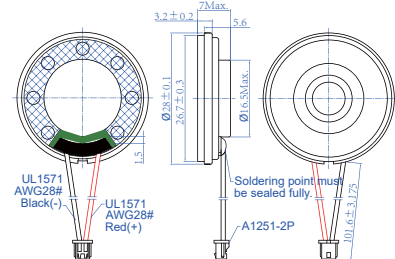

Frequency Curve

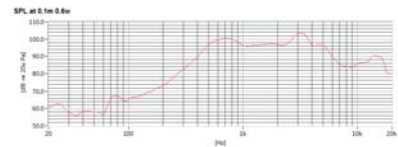

## CMS50RA7.9



Part Number	<b>CMS50RA7.9-50N0.5-1B350R</b>	
Rated Impedance	(ohm)	50 ± 15%
Rated (Max.) Power	(W)	0.5 (1)
Resonance Frequency	(Hz)	350 ± 20%
Frequency Range	(Hz)	f~ 4500
♦ Sound Pressure Level	(dB)	85 ± 3 at 1m1W
Operating Temperature	(°C)	-30~+70
Storage Temperature	(°C)	-40~+70
Weight	(g)	15

Dimensions (mm)

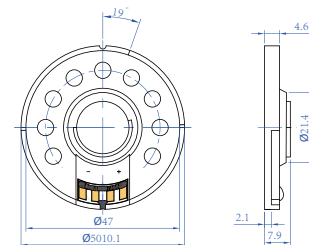

Frequency Curve



♦ Average of SPL values at 800, 1000, 1200 & 1500 Hz.

# Chinasound Loud Speaker

## CLS1420SB4



Part Number	<b>CLS1420SB4-8N0.5-2T900SR</b>	
Rated Impedance (ohm)	8 ± 15%	
Rated (Max.) Power (W)	0.5 (1)	
Resonance Frequency (Hz)	900 ± 20%	
Rated Frequency Range (Hz)	fo~10000	
Sound Pressure Level (dB)	87 ± 3 at 0.1m0.1 W	
Operating Temperature (°C)	-20~+60	
Storage Temperature (°C)	-30~+70	
Weight (g)	1.4	

Dimensions (mm)

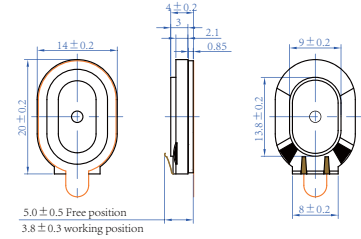

Frequency Curve

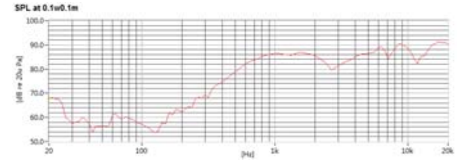

## CLS50S12



Part Number	<b>CLS50S12-8N1.5-T800R-1</b>	
Rated Impedance (ohm)	8 ± 15%	
Rated (Max.) Power (W)	1.5(3)	
Resonance Frequency (Hz)	800 ± 20%	
Rated Frequency Range (Hz)	fo~6000	
Sound Pressure Level (dB)	85 ± 3 at 1m1W	
Operating Temperature (°C)	-25~+60	
Storage Temperature (°C)	-30~+70	
Weight (g)	17.5	

Dimensions (mm)

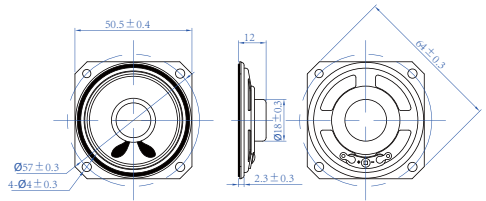

Frequency Curve

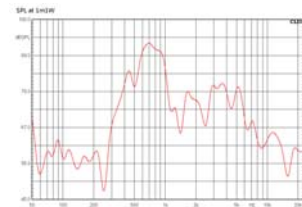

## CLS50R17



Part Number	<b>CLS50R17-16F3-T600-C26W100R</b>	
Rated Impedance (ohm)	16 ± 15%	
Rated (Max.) Power (W)	3 (4.5)	
Resonance Frequency (Hz)	600 ± 20%	
Rated Frequency Range (Hz)	fo~5000	
Sound Pressure Level (dB)	85dB min. at 3W 3meter at a point between 2.5KHz to 3.5KHz, at 25 °C	
Operating Temperature (°C)	-25~+60	
Storage Temperature (°C)	-30~+70	
Weight (g)	56.6	

Dimensions (mm)

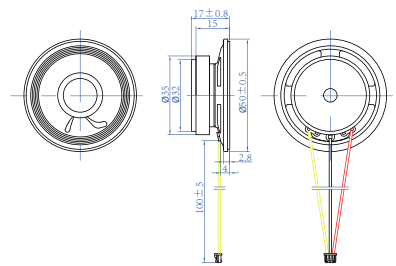

Frequency Curve

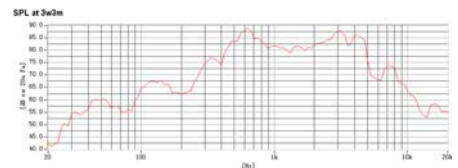

## CLS50RA18.2C



Part Number	<b>CLS50RA18.2C-25F0.5-B320-C16W45R</b>	
Rated Impedance (ohm)	25 ± 15%	
Rated (Max.) Power (W)	0.5 (1)	
Resonance Frequency (Hz)	320 ± 20%	
Rated Frequency Range (Hz)	fo~5000	
Sound Pressure Level (dB)	85 ± 3 at 1m1W	
Operating Temperature (°C)	-25~+60	
Storage Temperature (°C)	-30~+70	
Weight (g)	45	

Dimensions (mm)

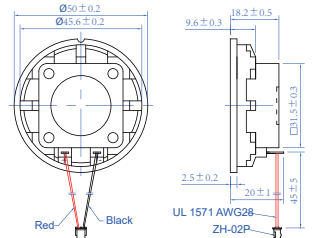

Frequency Curve

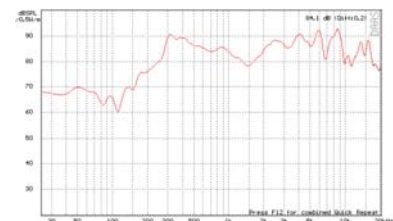

♦ Average of SPL values at 800, 1000, 1200 & 1500 Hz.